

SCALE 1:200

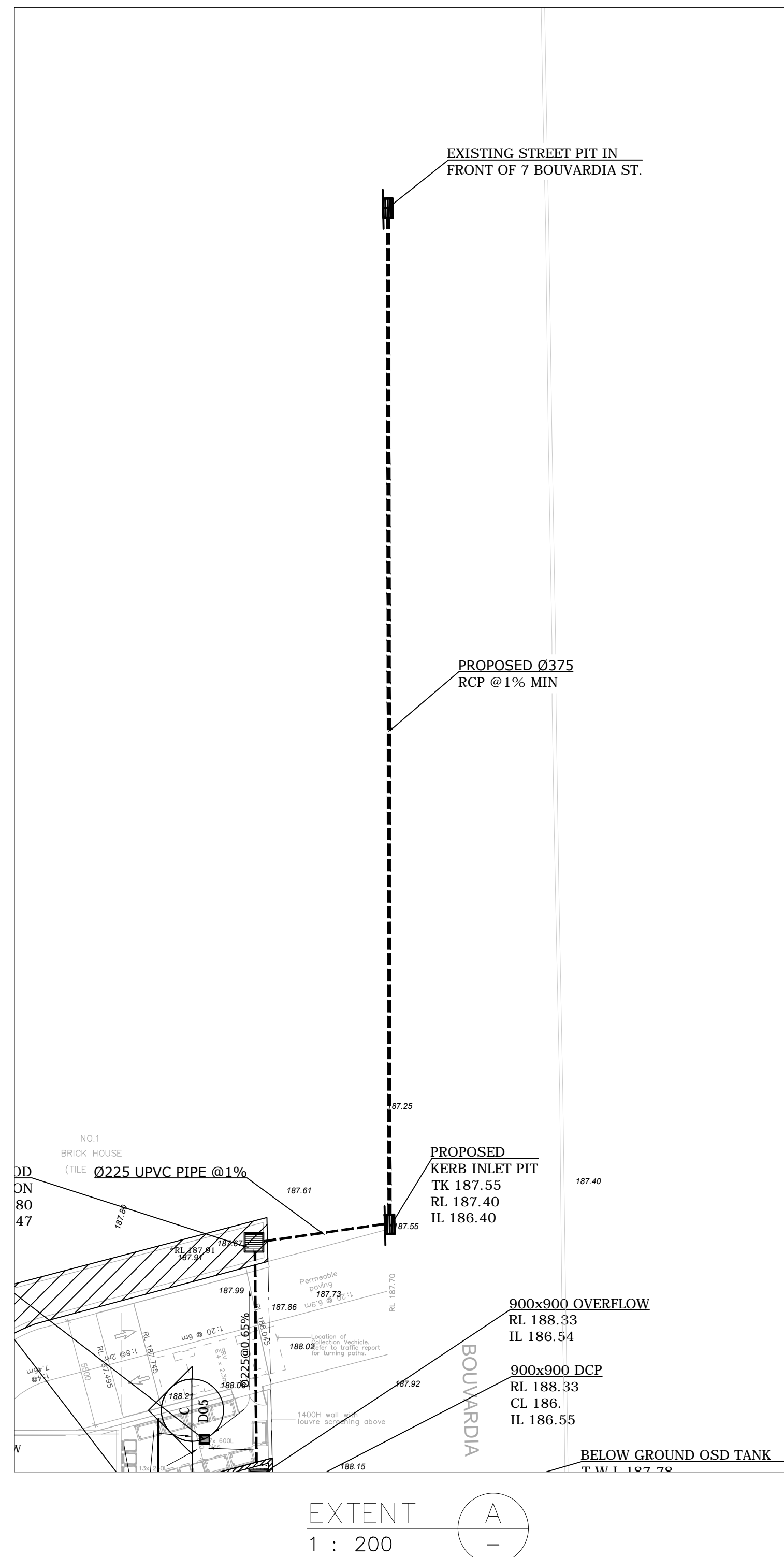

NOTE RE. SERVICES





APPROXIMATE LOCATIONS OF
EXISTING SERVICES SHOWN
ON LONGITUDINAL SECTION.
EXACT LOCATIONS & DEPTHS
TO BE ACCURATELY LOCATED BY
BUILDER CONTRACTOR BY CONTACTING
THE RELEVANT AUTHORITIES BEFORE
COMMENCEMENT OF ANY WORKS



NOTES

1. ALL LINES ARE TO BE MIN. 100Ø UPVC @ MIN 1.0% GRADE UNLESS NOTED OTHERWISE.
2. IT IS THE CONTRACTORS RESPONSIBILITY TO LOCATE & LEVEL ALL EXISTING SERVICES PRIOR TO THE COMMENCEMENT OF ANY EARTHWORKS. ALL DESIGN LEVELS SHOWN ON PLAN SHALL BE VERIFIED ON SITE PRIOR TO THE COMMENCEMENT OF ANY WORK.
3. ALL PIPES TO HAVE MIN 200mm COVER IF LOCATED WITHIN PROPERTY.
4. ALL PITS IN DRIVEWAYS BE HEAVY DUTY GRATES. DIRECT SURFACE FLOW TO ALL GRATED SURFACE INLET PITS.
5. ALL WORK DO BE DONE IN ACCORDANCE WITH AS/NZ 3500.3.2:2003 AND COUNCIL SPECIFICATIONS.
6. LOCATION OF DOWNPIPES & FLOOR WASTES ARE INDICATIVE ONLY. DOWNPIPE & FLOOR WASTE SIZE, LOCATION & QUANTITY TO BE DETERMINED BY BUILDER & IN ACCORDANCE WITH RELEVANT AUSTRALIAN STANDARDS.
7. THIS PLAN IS TO BE READ IN CONJUNCTION WITH THE ARCHITECTURAL, LANDSCAPE AND STRUCTURAL PLANS.
8. ANY DISCREPANCIES OR OMISSIONS SHALL BE REFERRED TO THE DESIGN ENGINEER FOR RESOLUTION.
9. ALL PITS OR GRATES IN TRAFFICABLE AREAS TO BE HEAVY DUTY.
10. ALL GUTTERS WILL BE FITTED WITH LEAF GUARDS AND SHOULD BE INSPECTED AND CLEANED TO ENSURE LEAF LITTER CANNOT ENTER THE DOWNPIPES

SYMBOLS

F.F.L.	FINISHED FLOOR LEVEL
T.K.	TOP OF KERB
RL	PIT SURFACE LEVEL
IL	INVERT LEVEL
----	STORMWATER DRAINAGE PIPE
-----	DOWNPIPE TO RAINWATER TANK
• DP	100Ø DOWN PIPE (U.N.O.)
• VD	VERTICAL DROP PIPE
• VR	VERTICAL RISER
• IO	INSPECTION OPENING
////	MASONRY RETAINING WALL
• FW	FLOOR WASTE 150Ø
	GRATED INLET PIT
	GRATED DRAIN
	OVERLAND FLOW PATH
	SPREADER

NOTES: DRAINAGE LINES

DRAINAGE LINES SHOWN continuous TO COLLECT SURFACE WATER

DRAINAGE LINES SHOWN DASHED TO COLLECT ROOF WATER ONLY TO RAINWATER TANK

NOTES: COUNCIL ISSUED FOOTWAY DESIGN LEVELS

COUNCIL'S ISSUED FOOTWAY DESIGN LEVELS TO BE INCORPORATED INTO THE
FINISHED LEVELS ONCE ISSUED BY COUNCIL

NOTES: ROAD RESERVE & FOOTWAY DRAINAGE ELEMENTS

ALL STORMWATER DRAINAGE ELEMENTS PROPOSED WITHIN THE ROAD RESERVE AND FOOTWAY SHALL BE CONSTRUCTED UNDER THE SUPERVISION AND TO THE SATISFACTION OF COUNCIL'S ENGINEER.

NOT FOR CONSTRUCTION

A1	0	1	2	3	4	5	6	7	8	9	10
E	FOR D.A. APPROVAL					N.L.	J.L.	12-03-16			
F	FOR D.A. APPROVAL					N.L.	L.Y.	20-01-16			
D	FOR AMENDMENT					N.L.	L.Y.	07-12-15			
C	FOR D.A. APPROVAL					N.L.	S.C.	25-09-15			
B	FOR D.A. APPROVAL					N.L.	S.C.	17-09-15			
A	FOR D.A. APPROVAL					N.L.	S.C.	31-08-15	G		FOR D.A.
No	AMENDMENT					ENG	DRAFT	DATE	No		

ARCHITECT

JHArchitects

JH Architects Pty Ltd

M: 0412287606

LEVEL 5, 104 COMMONWEALTH
STREET, SURRY HILLS, NSW 2010



COPYRIGHT: THIS DESIGN AND PLANS ARE NOT TO BE USED OR REPRODUCED WHOLLY OR IN PART WITHOUT WRITTEN PERMISSION OF LOKA CONSULTING ENGINEERS PTY LTD.

LOKA

ENGINEERS PTY LTD

SUITE 2, LEVEL 1, 55-59 PARRAMATTA ROAD, LIDCOMB

LOKA CONSULTING ENGINEERS PTY LTD
www.lceng.com.au

PROJECT

PROPOSED RESIDENTIAL DEVELOPMENT
325-327 & 331 PEATS FERRY RD
ASQUITH, NSW

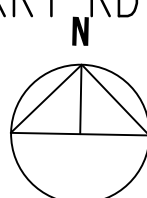

SHEET SUBJECT

GROUND FLOOR / SITE STORMWATER DRAINAGE PLAN

PROJECT 325-327 & 331 PEATS FERRY RD, ASQUITH, NSW			
DATE MAR 16	DRAWN J.L.	DESIGNED N.L.	CHECKED N.L.
SCALE 1:100 U.N.O.		JOB No 15NL243	
AUTHORISED NERMEIN LOKA		DWG No D04	REV G